

Pipe Flange

HYDRAULIC SPREADERS

5 & 10 Ton
700 bar

- You'll never again have to resort to "hammer and chisel" methods that waste time and effort. Flange spreaders should be used in pairs to provide even spreading force.
- Standard 60° wedge is suitable for most flanges; 30° "thin" and 60° "blunt" wedges are optional.
- The HFS3A is designed for applications where total thickness of flanges and max. spread gap is 76,2mm or less and flange bolts are a min. of 17,5mm dia.
- Use HFS6A if total thickness of flanges and max. spread gap is 152,4 mm or less, and flange bolts are a min. of 20,7 mm dia.

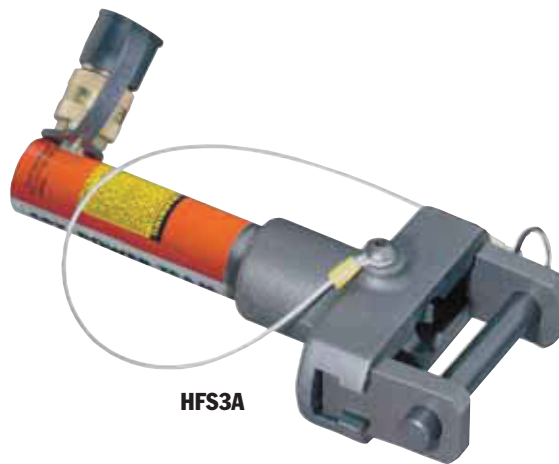

HFS3A

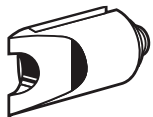

350823
(30° Thin wedge)

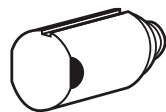

350822
(60° Blunt wedge)



350549
(30° Thin wedge)



350550
(60° Blunt wedge)

Capacity (tons)	Order Number	Standard Wedge Type	Optional Wedges		Min. Flange Opening (mm)			Max. Flange Opening (mm)			Combined Flange Opening (mm)	Max. Pin Dia. (mm)	Weight (kg)
			30° Thin	60° Blunt	60° Std.	60° Blunt	30°	60° Std.	60° Blunt	30°			
5	HFS3A	60° Sharp	350823	350822	1,6	25,4	1,6	38,1	38,1	18,3	76,2	17,4	4,1
10	HFS6A	60° Sharp	350549	350550	1,6	38,1	1,6	50,8	50,8	24,6	152,4	20,6	8,2

* 30° Thin wedge provides more than twice spreading force of 60° wedge.
* 60° Blunt-faced wedge for wide flange openings.